



CENTA GROUP
COMPLETE FIRE PROTECTION

INSPECTION & MAINTENANCE:

It is a requirement of the OSH Act that all fire extinguishers be maintained in accordance with the manufacturers specifications and **SANS 1475**.

INSPECTION is a quick test to ascertain that the extinguisher is working. Check the discharge hose to ensure the unit has not been discharged, that there is no obstruction of the discharge device and the gauge is showing pressure. Using a pressure testing tester, ensure the pressure in the cylinder is as per the stated specifications.

MAINTENANCE of **CENTA** fire extinguishers must be carried out in accordance with the procedures as laid out in **SANS 1475**.

SERVICING PROCEDURE:

Servicing **CENTA** products may only be undertaken by registered **SAQCC-Fire 1475** competent persons, who are employed by a **SANS 1475** approved company. Servicing and servicing intervals must comply with **SANS 1475**.

SERVICING TIPS:

1. When commencing servicing ensure the unit is not under pressure, regardless of the gauge reading. Partially release the pressure relief valve. If a hissing sound is heard release pressure before working on the unit.
2. It is dangerous to 'break/unscrew' the valve, as a valve thread release may not be present.
3. When filling a foam extinguisher premix the foam and water before gently pouring into the unit.
4. Using a light film of grease on the cylinder neck and valve neck 'O' ring prevents leakage and preserves the 'O' ring.
5. When refitting a valve to a cylinder always replace the valve neck 'O' ring and ensure aluminum valve threads are greased.
6. Use a light solvent to clean all parts of the valve.
Do not grease valve stem 'O' ring.

WARNING:

Only pressurized stored pressure extinguishers with dry nitrogen from a cylinder with a regulator set at no greater than 1500kpa. Never pressure without a regulator.

TOOL REQUIREMENTS:

The following tools will assist in the productive servicing of **CENTA** fire extinguishers:

- CENTA valve spanner
- No 10 spanner removes pressure relief nut
- No 14 spanner removes nozzle
- No 22 spanner removes gauge
- Light hammer removes valve handle pin



FIRE EXTINGUISHER

9.0 KG Standard (AA0914)



SPECIFICATIONS:

Height (mm):	540
Diameter (mm):	175
Mass Empty (kg):	3.26
Mass Full (kg):	12.26
Charge:	40% MAP
Expellant:	Nitrogen
Discharge distance (m):	14
Working pressure (kPa):	1500
Paint coating:	Heavy Epoxy Powder Coating
Compliance:	SANS 1910

CENTA HEAD OFFICE:

Unit 5, 3 Sasswood Road, Glen Anil, Durban North, SA
CALL: 0860 10 20 41 EMAIL: centa@centa.co.za

WWW.CENTA.CO.ZA

EXPLODED VIEW

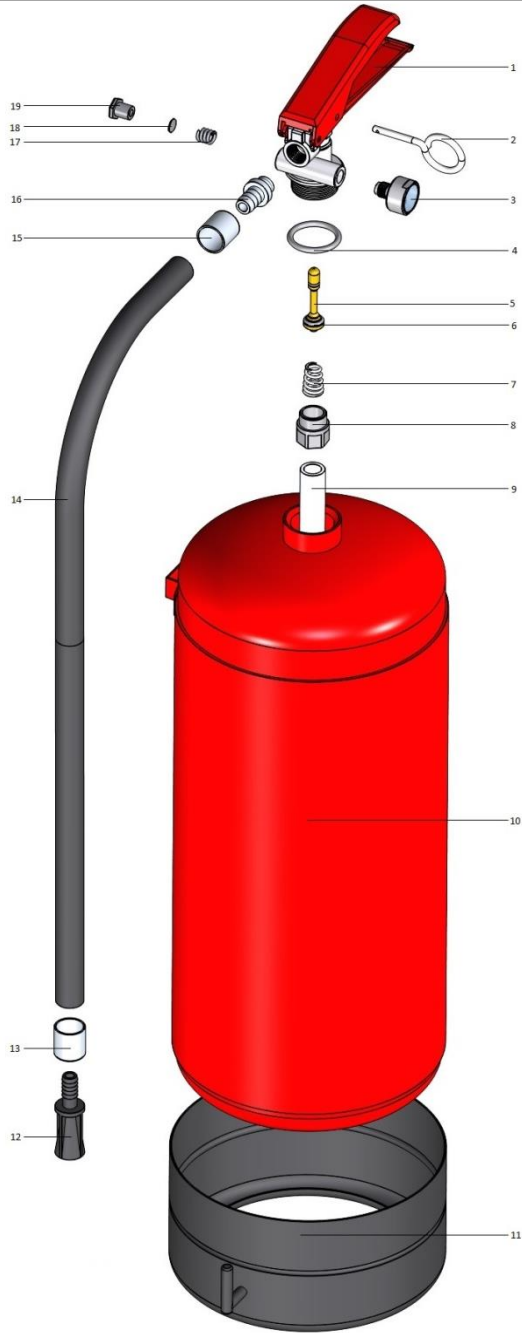

CENTA GROUP

COMPLETE FIRE PROTECTION

1	A08016	Large handle valve
2	AS2100	Safety Pin
3	A07999	Standard Pressure Gauge
4		O-Ring
5	AS1700	Plunger
6		O-Ring
7		Plunger Spring
8	AS2300	Siphon Tube Holder
9	A08112	Siphon Tube
10	-	Cylinder
11	-	Base
12		Nozzle
13		Crimp
14		Hose
15		Crimp
16	A10214	Hose Connector
17		Relief Valve Spring
18	AS1800	Relief Valve Sealing Cap
19		Relief Valve Nut

TROUBLESHOOTING GUIDE

WARNING:

DO NOT service an extinguisher until ALL internal pressure has been released. It is advisable to determine leaks before releasing the pressure.

PROBLEM	CORRECTIVE ACTION
UNIT LOSING PRESSURE	CHECK: <ul style="list-style-type: none"> •Cylinder for pin hole leak •Valve for leak •Neck 'O' ring joint for leak
VALVE LEAK	CHECK VALVE STEM: <ul style="list-style-type: none"> •'O' ring is clean and has not been cut. •Chamber is clean.
GAUGE THREAD LEAK	Remove gauge, and reinstall using loctite or thread tape on the gauge thread. Clean 'O' Ring on valve.
NECK 'O' RING LEAK	Remove valve. Ensure neck ring area is free of dirt. Remove excess paint. Replace valve neck 'O' Ring. Grease the neck and neck 'O' Ring. Replace the valve.
DEFECTIVE GAUGE	Excessive shock can damage gauges. If damaged, remove gauge and replace.
CYLINDER LEAK	CENTA units carry a conditional warranty. If the unit is under 3 years old and in a good condition, the cylinder will be replaced.

EXTINGUISHER MAINTENANCE INTERVALS

TYPE	CONTAINER MATERIAL	STORED PRESSURE OPERATION	MAINTENANCE INTERVALS	
			MAINTENANCE (years)	INTERNAL INSPECTION & PRESSURE TEST (years)
Dry powder	MS	SP	1	5
	SS	SP	1	5
Water	MS	SP	1	5
	SS	SP	1	5
Foam	MS	SP	1	5
	SS	SP	1	5
CO2	AL	SP	1	10 *
	CrMo	SP	1	10 *