



CENTA GROUP
COMPLETE FIRE PROTECTION

INSPECTION & MAINTENANCE:

It is a requirement of the OSH Act that all hose reels must be maintained in accordance with the Manufacturers specifications and **SANS 1475**.

INSPECTION is a quick test to ascertain that the hose reel is working. Check the discharge nozzle is not obstructed. Check the CP valve or ball valve flow control is operating.

Without unwinding the hose check that water is able to flow from the discharge nozzle.

MAINTENANCE of **CENTA** Hose reels must be carried out in accordance with the procedure as laid out in **SANS 1475**

SERVICING PROCEDURE:

Servicing **CENTA** products may only be undertaken by registered **SAQCC-Fire 1475** competent persons, who are employed by a **SANS 1475** approved company. Servicing and servicing intervals must comply with **SANS 1475**.

SERVICING TIPS:

1. Before unrolling the hose to check for leaks, turn the CP Valve or Ball Valve OFF.
2. Ensure connectors at gooseneck on the waterway and discharge nozzle have been tightened.
3. It only requires the removal of the front nut on a **CENTA** hose reel to remove the disc assembly and hose from the frame. Ensure water is turned OFF and always have a bucket handy.
4. 'O' Rings on the spindle must be replaced with each service.
5. Before replacing the disc assembly and hose ensure the waterway and 'O' Rings have been well greased.
6. Twist the disc assembly and hose onto the spindle, this prevents the 'O' Rings from being accidentally cut.

TOOL REQUIREMENTS:

The following tools will assist in the productive servicing of the **CENTA** Hose Reel:

- No 10 spanner removes the hub spacer bolts
- No 12 spanner removes the front nut
- Flat screw driver secures jubilee clamps



HOSE REEL

Corrosion Proof (BB0210)



SPECIFICATIONS:

Hose Capacity (m):	30
Spindle:	Stainless Steel
Waterway:	Plastic
Hub Spacer:	M/Steel Electro Galvanised
Discs:	M/Steel Electro Galvanised
Frame:	M/Steel Electro Galvanised
Coating:	Heavy Epoxy
Nozzle:	Jet / Spray
Nozzle Material:	Nylon
Frame Mass (Kg):	5.98
Complete Mass (Kg):	16.94 (c/w 30m PVC Hose)
Compliance:	SANS 543

CENTA HEAD OFFICE:

Unit 5, 3 Sasswood Road, Glen Anil, Durban North, SA
CALL: 0860 10 20 41 EMAIL: centa@centa.co.za

WWW.CENTA.CO.ZA

EXPLODED VIEW

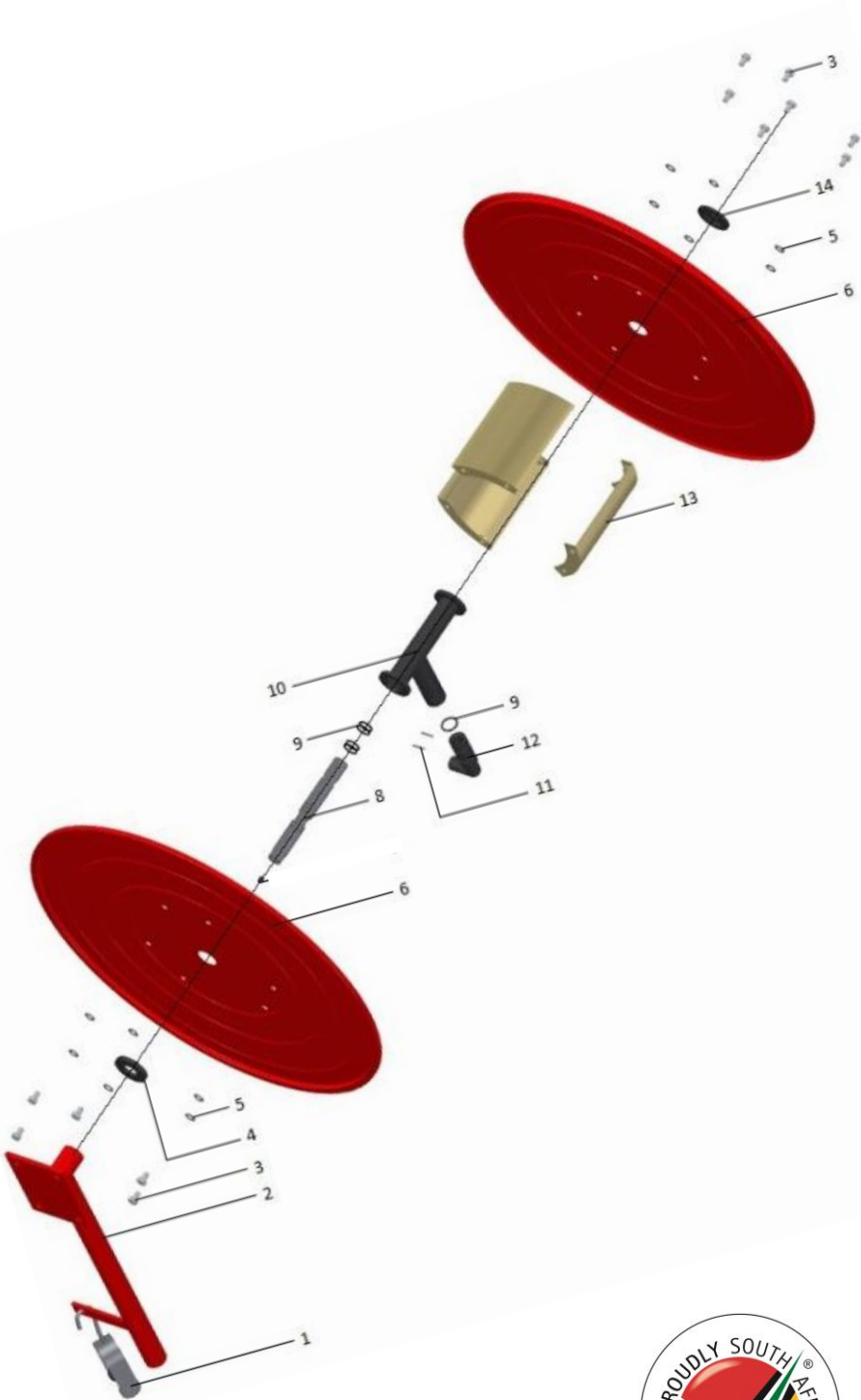

1	Stirrup (Passivated)	BB0105A
2	Backing Plate with	BB1123
	Downpipe (Powder Coated & Passivated)	
3	Bolts	B08017
4	Washer (Back)	BS0800
5	Nuts	B08017
6	Disc (Powder Coated)	B05000
8	Spindle with	B06003
9	'O' Rings	
10	Waterway (Plastic)	BB1110
11	Securing Pins	-
12	Waterway Elbow	BB1110
13	Hub Spacer	BB0106
14	Washer (Front)	BS0700

TROUBLESHOOTING GUIDE

PROBLEM	CORRECTIVE ACTION
NO WATER DISCHARGE	Ensure the waterway has been installed the correct way around.
LEAK AT SPINDLE	<ul style="list-style-type: none"> Remove disc assembly. Check spindle 'O' Rings are not damaged. Replace 'O' Rings – grease well Twist disc assembly back into place.
LEAK AT ELBOW	<ul style="list-style-type: none"> Remove waterway. Press elbow pins out Remove elbow and check 'O' Ring. Replace 'O' Ring – grease well Re-assemble waterway
LEAK AT CP VALVE / BALL VALVE	<ul style="list-style-type: none"> Replace valve

SERVICING INTERVAL

ANNUALLY